

**Information - RF-PACK3 30 Linear Ft. Run4 Panels – 5 Bases – 1 Swing Gate**

- Panel is durable and weighs 37 lbs.
- 8 gauge welded wire
- 2" x 4" wire mesh
- 87" w x 72" h panel with center vertical support bar
- Durable 2 step finish – zinc enriched primer coat is covered with Tiger Yellow powder, final coat.

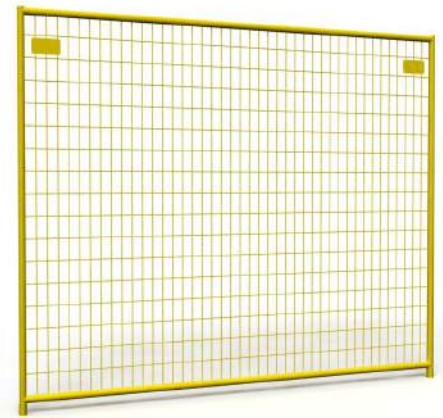

**Specifications RF-PACK3**

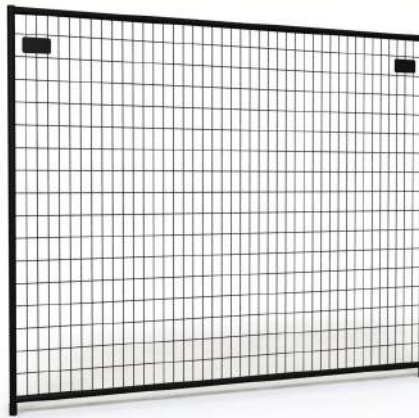
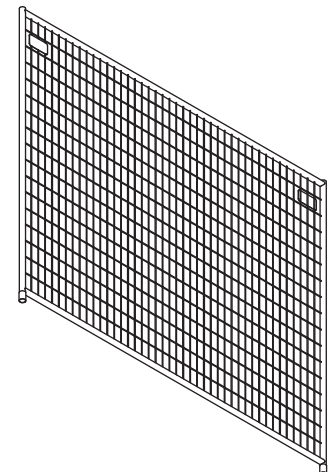
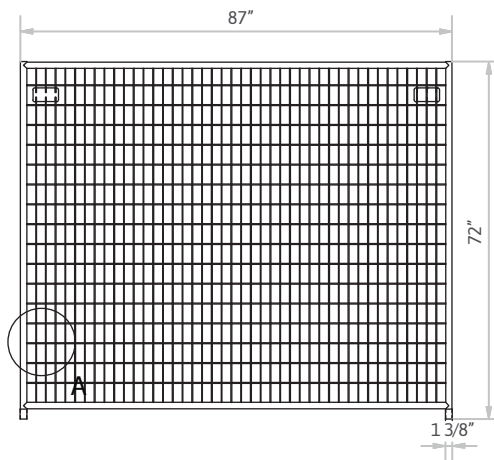
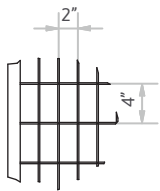

STANDARD COLORS  